



IMPORTANT SAFETY INSTRUCTIONS SAVE THIS MANUAL

PLEASE READ THE ENTIRE CONTENTS OF THIS MANUAL PRIOR TO INSTALLATION AND OPERATION. BY PROCEEDING WITH THIS HEAVY DUTY WORK BENCH ASSEMBLY YOU AGREE THAT YOU FULLY UNDERSTAND AND COMPREHEND THE FULL CONTENTS OF THIS DOCUMENT. FORWARD THIS IMPORTANT MANUAL TO ALL OPERATORS.

Revision A 12-30-2015
P/N 5900961

OPERATION AND ASSEMBLY MANUAL

MODELS:

- RWB-2D** 2-DRAWER HEAVY DUTY WORK BENCH
- RWB-2S** 2-SHELF HEAVY DUTY WORK BENCH
- RWB-1TD** HEAVY DUTY WORK BENCH WITH FLUID CATCH



READ FIRST



Do not operate this machine until you read and understand all the dangers, warnings and cautions in this manual.

RECEIVING

The shipment should be thoroughly inspected as soon as it is received. The signed Bill of Lading is acknowledgement by the shipping carrier as receipt of this product as listed in your invoice as being in a good condition of shipment. If any of these goods listed on this Bill of Lading are missing or damaged, do not accept merchandise until the shipping carrier makes a notation on the freight bill of the missing or damaged goods. Do this for your own protection.

BE SAFE

Your new work bench was designed and built with safety in mind. However, your overall safety can be increased with proper training and thoughtful operation on the part of the operator. DO NOT operate or repair this equipment without reading this manual and the important safety instructions shown inside. Keep this operation manual near the alignment system at all times. Make sure that ALL USERS read and understand this manual.



1645 Lemonwood Dr.
Santa Paula, CA. 93060, USA
Toll Free 1-800-253-2363
Tel: 1-805-933-9970
Fax: 1-805-933-9160
www.bendpak.com

INDUSTRIAL GRADE 2-DRAWER WORK BENCH

Model RWB-2D

Height: 34-1/2" / 876 mm

Depth: 25-1/4" / 641 mm

Width: 59" / 1499 mm

No. Drawers: 2

PART NUMBER	DESCRIPTION
1	Workbench Top with Two Drawers
2	Shelf
3	Leg
4	Bolt with Washer
5	Key for Drawer A
6	Key for Drawer B

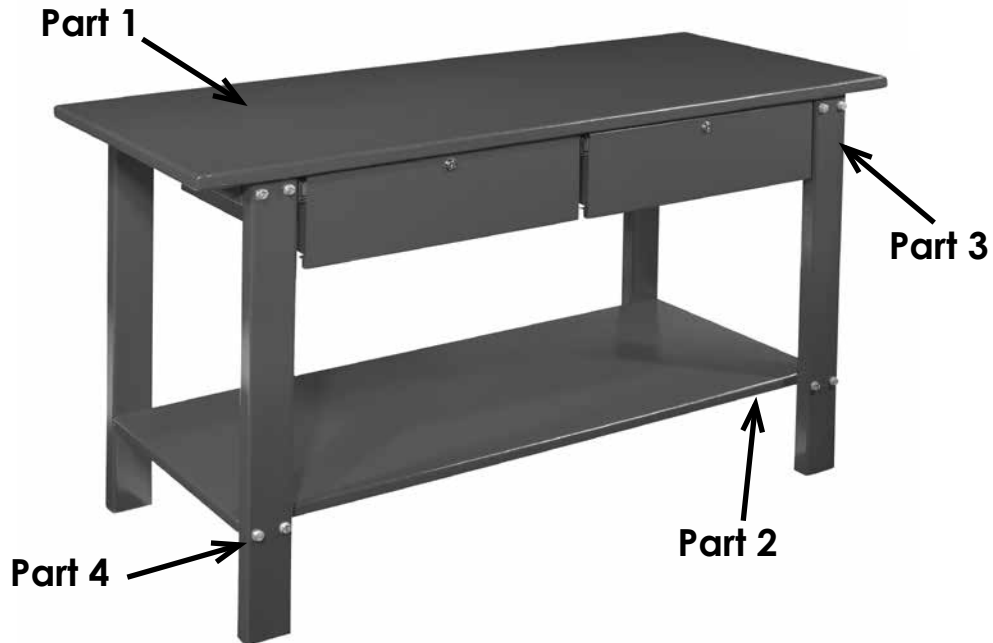

ASSEMBLY

1. Place workbench top (#1) upside down on a smooth surface
2. Attach the four legs (#3) to workbench top (#1) by bolts with washers (#4), then finger tighten
3. Attach the shelf (#2) to the legs (#3) by bolts with washers (#4), then finger tighten
4. Set the workbench upright, check its level, then tighten all the hardware with a wrench
5. If the drawers are not installed, push on the black plastic levers on the sides of the drawer. Left side of drawer lever pressed up. Slide into drawer slot on (#1) workbench top
6. Check if the keys work properly. Each drawer has its own two keys.

INDUSTRIAL GRADE 2-SHELF WORK BENCH

Model RWB-2S

Height: 34-1/2" / 876 mm

Depth: 25-1/4" / 641 mm

Width: 79" / 2009 mm

No. Shelves: 2

PART NUMBER	DESCRIPTION
1	Workbench Top
2	Shelf
3	Leg
4	Bolt with Washer

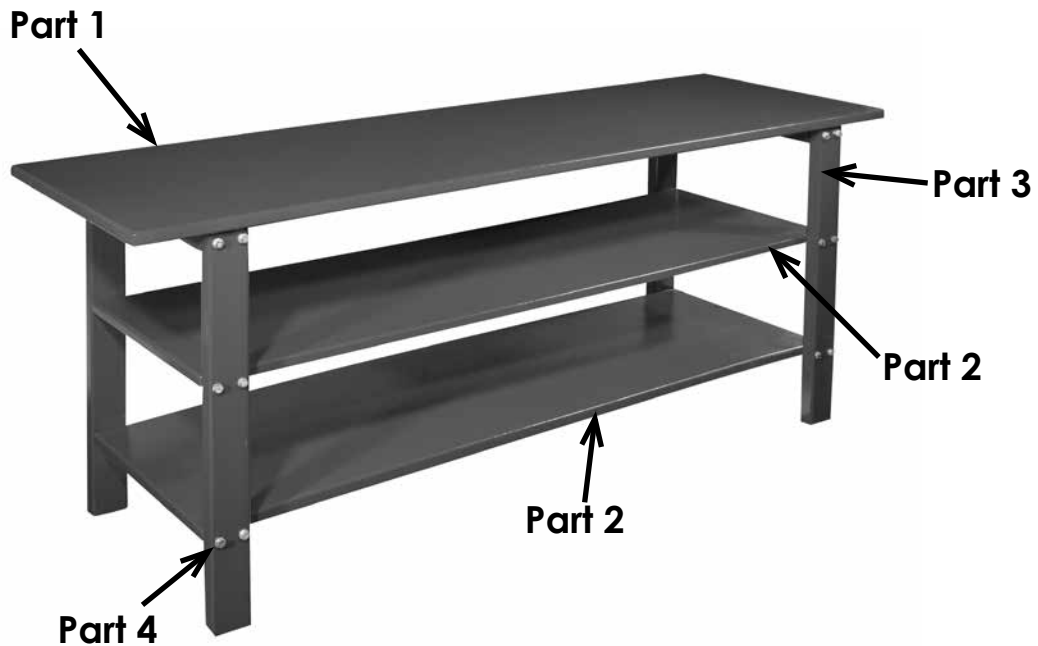

ASSEMBLY

1. Place workbench top (#1) upside down on a smooth surface
2. Attach the four legs (#3) to workbench top (#1) by bolts with washers (#4), then finger tighten
3. Attach the shelf (#2) to the legs (#3) by bolts with washers (#4), then finger tighten
4. Set the workbench upright, check its level, then tighten all the hardware with a wrench

INDUSTRIAL GRADE 2-DRAWER WORK BENCH

Model RWB-1TD

Height: 40" / 1016 mm

Depth: 32" / 813 mm

Width: 48" / 1219 mm

Drawers/Shelves: 1/1

PART NUMBER	DESCRIPTION
1	Workbench Top with Drawer and Oil Receiver Tray
2	Shelf
3	Side Beams
4	Leg
5	Bolt with Washer
6	Casters
7	Key for Drawer

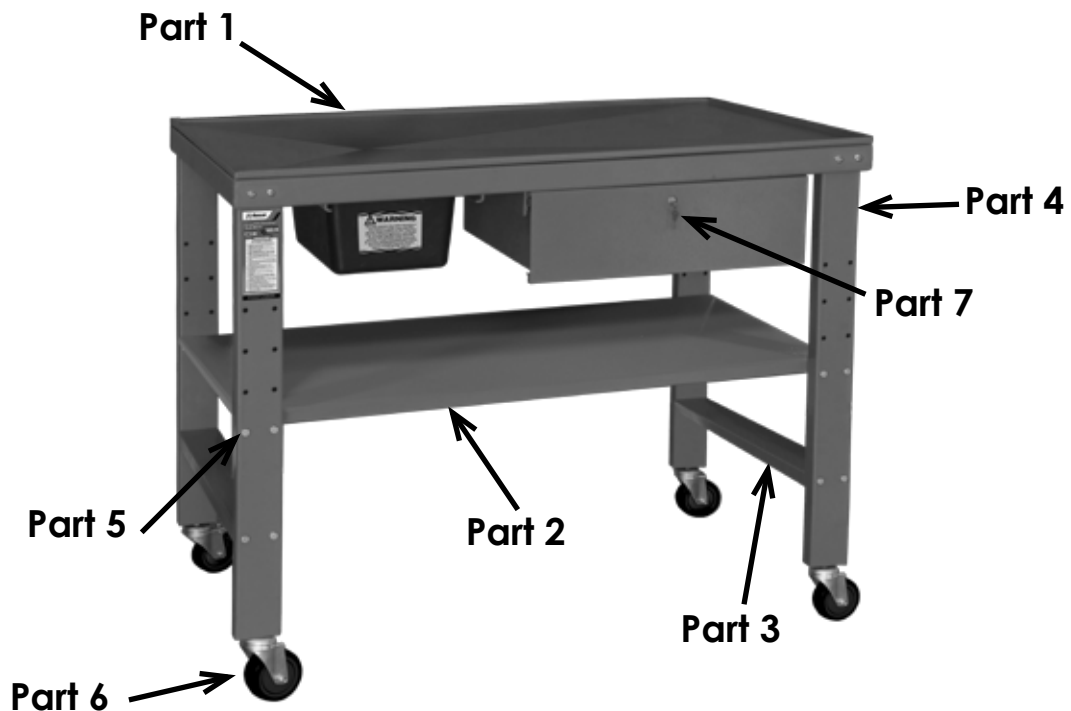

ASSEMBLY

1. Place workbench top (#1) upside down on a smooth surface
2. Attach the four legs (#4) to workbench top (#1) by bolts with washers (#5), then finger tighten
3. Attach the shelf (#2) to the legs (#4) by bolts with washers (#5), then finger tighten. Shelf can be adjust it to desired height. Attach side beams (#3) to the lower part of the legs.
4. Insert casters (#6) to all four legs
5. Set the workbench upright, check its level, then tighten all the hardware with a wrench
6. If drawer is not installed, slide into drawer slot on right side of (#1) workbench top
7. Install Plastic Oil Receiver Tray on the left side of (#1) workbench top
8. Check if the keys (#7) work properly. The drawer comes with two keys

PARTS BREAKDOWN

NO	SPEC.	QTY.
1	M8*100Bolt	4
2	M8*55Bolt	12
3	M8 Washer	12
4	M8 nut	20
5	work top	1
6	leg	4
7	shelf	1

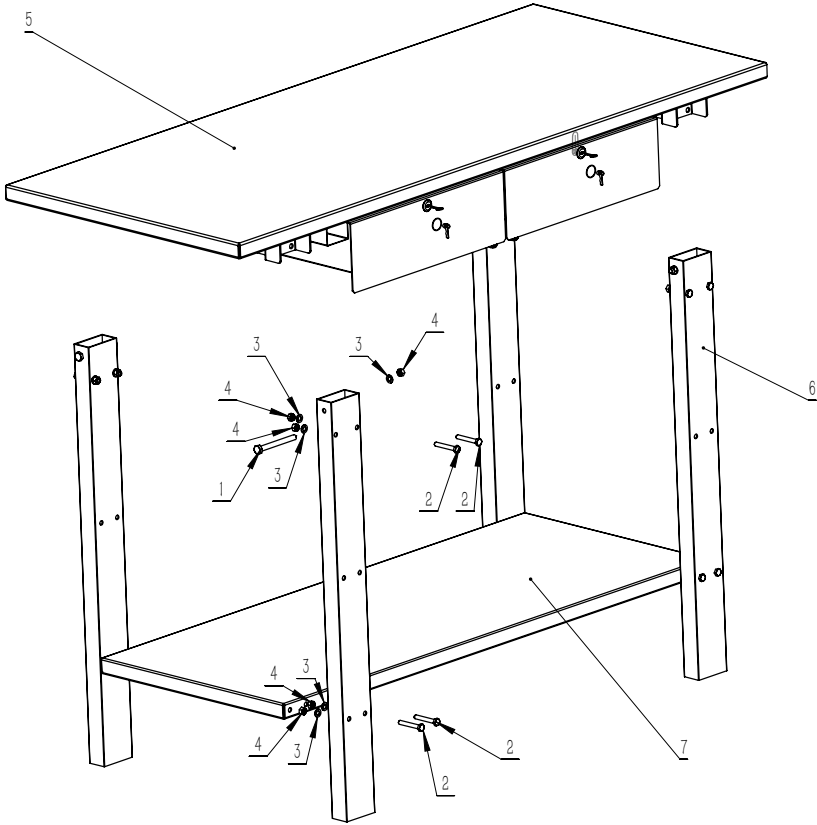

RWB-2D

NO	SPEC	QTY
1	M8*55bolt	28
2	M8 nut	28
3	M8 washer	28
4	shelf	2
5	leg	4
6	work top	1

RWB-2S

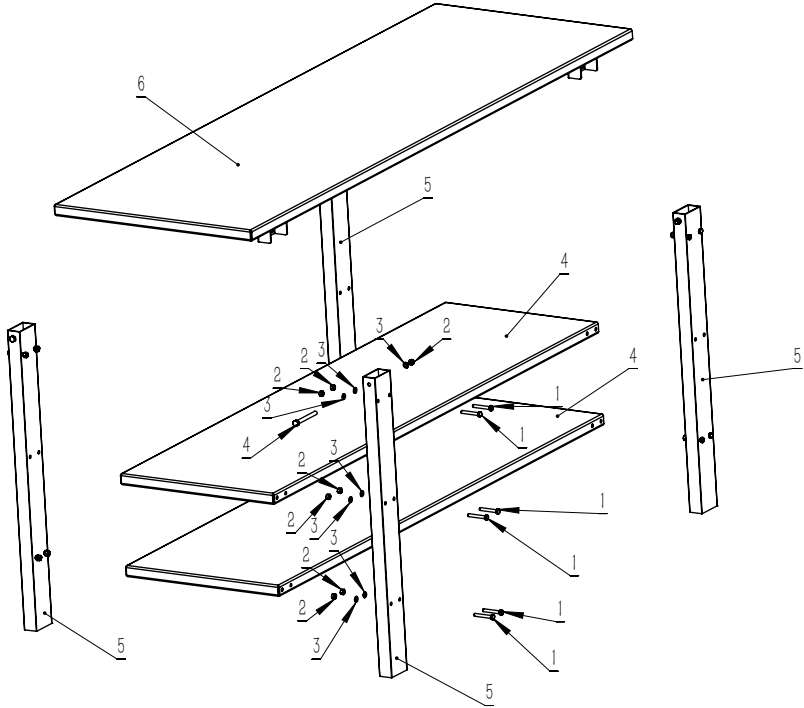

PARTS BREAKDOWN

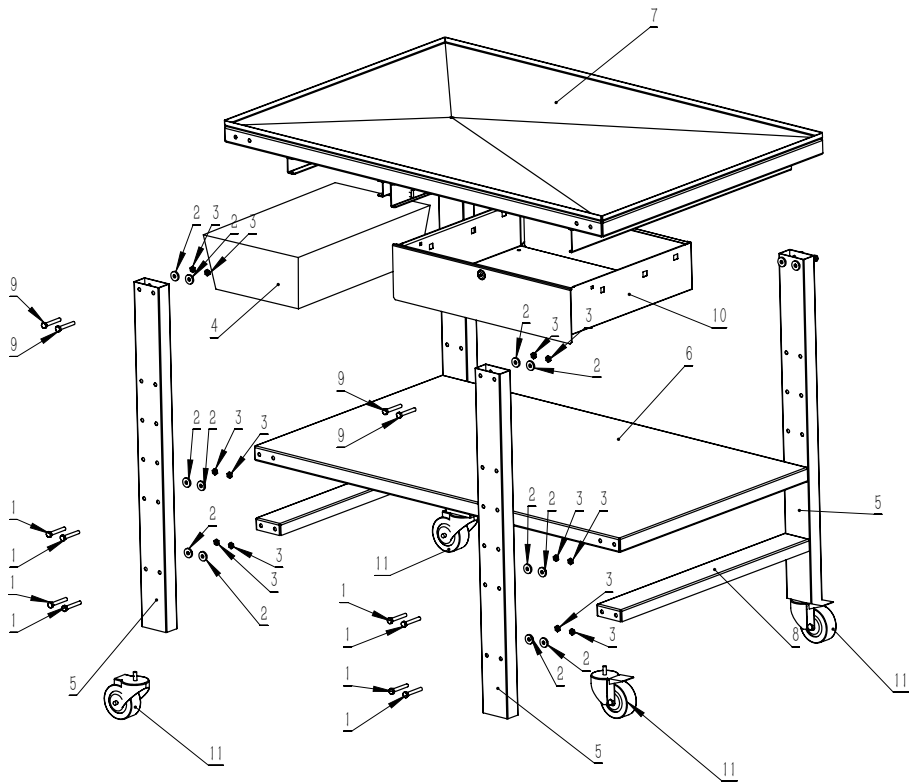

NO.	SPEC.	QTY.
1	M8*55 bolt	16
2	M8 washer	24
3	M8nut	24
4	plastic box	1
5	oil receiver tray	4
6	shelf	1
7	work top	1
8	beam	1
9	M8*75 bolt	8
10	drawer	1
11	casters	4

RWB-1TD



For Parts or Service Contact:

BendPak Inc. / Ranger Products
1645 Lemonwood Dr.
Santa Paula, CA 93060

Tel: 1-805-933-9970
Toll Free: 1-800-253-2363
Fax: 1-800-933-9160

www.bendpak.com