

Ergo - Scoot™ Low-Profile Creeper

Assembly and User Guide

Guide P/N: 5900300 Rev. A- May 2023

Ergo-Scoot Description

The Ergo-Scoot™ (5160118) is a reclining low-profile creeper seat. Providing increased mobility on a stable platform as you work on, around and under Vehicles. A gas spring supports the backrest allowing positions from ≈5° to 60° while four 360° swivel casters allow freedom of movement and comfort while working.

Included with the Scoot:

- Assembly and User Guide
- 2 Tool/Parts Trays
- Spacer Kit (increases ground clearance to ≈1.2 in. / 30 mm)
- Riser Kit - **Adds ≈8 to 12 in. (200 to 300 mm)**

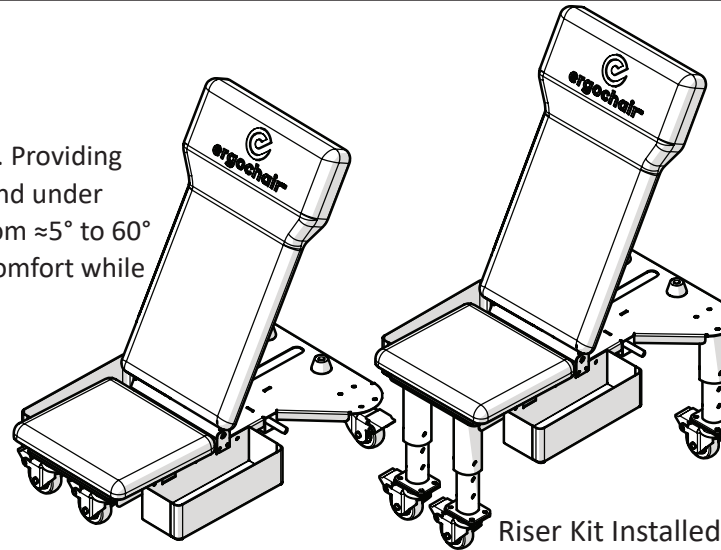

Riser Kit Installed

Copyright. Copyright ©2023 BendPak Inc. All rights reserved. You may make copies of this document if you agree that: you will give full attribution to BendPak Inc., you will not make changes to the content, you do not gain any rights to this content, and you will not use the copies for commercial purpose.

Trademarks. Ergochair and the Ergochair logo, BendPak and the BendPak logo are registered trademarks of BendPak Inc. All other company, product, and service names are used for identification only. All trademarks and registered trademarks mentioned in this Manual are the property of their respective owners.

Limitations. Every effort has been made to ensure complete and accurate instructions are included in this Guide. However, product updates, revisions, and/or changes may have occurred since this Guide was published. BendPak reserves the right to change any information in this Guide without incurring any obligation for equipment previously or subsequently sold. BendPak is not responsible for typographical errors in this Guide. You can always find the latest version of the Assembly and User Guide for your product on the BendPak website.

Warranty. The BendPak warranty is more than a commitment to you: it is also a commitment to the value of your new product. Contact your nearest BendPak dealer or visit www.bendpak.com/support/warranty for full warranty details.

Go to bendpak.com/support/register-your-product/ and fill out the online form to register your product (be sure to click Submit).

Safety. Your Ergo-Scoot was designed and manufactured with safety in mind. However, your safety also depends on proper training and thoughtful operation. Do not install, operate, maintain, or repair the unit without reading and understanding this Assembly and User Guide and the labels on the unit. **Do not use the Ergo-Scoot unless you can do so safely!**

Ergo-Scoot Safety Information



- **Please read this entire guide prior to use.** Failure to follow the instructions and safety precautions in this guide can result in serious injury. By proceeding with setup and operation, you agree that you fully understand the contents of this guide and assume full responsibility for the use of this product. **Always** inspect the Scoot for loose or damaged components prior to each use. If a problem exists resolve the issue. If the issue cannot be resolved, cease all use and contact your authorized Ergochair parts provider.
- **Always** be alert and aware of dangers around you while using this equipment.
- **Only** use the Scoot on hard, flat surfaces.
- **Always sit down on the Ergo-Scoot gently.** Avoid shock loads caused by jumping or falling onto the seat.
- **Never** stand on the Ergo-Scoot or use it for a purpose for which it was not designed.
- **Do not** allow unsupervised children or persons to use this product.
- This product is **not** a toy. **Never** use as a skateboard or dolly.
- **Beware of pinch and crush hazards** when using or adjusting the seat position on this product. When making seat adjustments, keep hands clear.
- **Be aware of the Maximum Weight limit for the Ergo-Scoot.** Do not remove Vehicle components that, when combined with your own weight, exceed the maximum weight rating of 350 lbs. / 159 kg.
- **Replace warning labels that are damaged or illegible.**
- **Do not** operate your Ergo-Scoot if you find maintenance issues or it operates in an abnormal manner. Take it out of service, then contact BendPak Technical Support, email support@bendpak.com or call (800) 253-2363 option 7, then 4.



Ergo-Scoot Specifications:

A	Length (backrest up)	32 in. / 813 mm
B	Seat Width	14.8 in. / 376 mm
C	Max. Width	23.6 in. / 600 mm
D	Headrest Width	17.75 in. / 451 mm
E	Seat Height	6.9 in. / 175 mm*
F	Height (backrest up)	31.5 in. / 800 mm*
G	Length (backrest down)	45.7 in. / 1,160 mm
H	Height (backrest down)	9.5 in. / 241 mm*
I	Backrest Angle	≈5° to 60°
J	Ground Clearance	.4 in / 10 mm* (3 in./ 76.2 mm w/o Trays)

- **Ergo-Scoot Weight:** 87 lbs. / 39.5 kg.
- **Backrest Adjustment Angle:** 0° to ≈60°
- **Backrest Locking Mechanism :** Gas Spring
- **Casters:** Four 360° Casters (2 locking), Ø75 mm x 25 mm, sleeve bearings, oil resistant, non-marking rubber wheels
- **Seat Materials:** Padded Marine Vinyl Backrest and Seat. Marine Vinyl is abrasion, chemical and oil resistant
- **Frame Materials:** Full powder coated, welded tubular steel
- **Tool Box** inside dimensions: 13.75 x 4.6 x 3.75 in. / 349 x 117.4 x 95.2 mm

*Caster Kit adds ≈1.2 in. / 30 mm.

Riser Kit adds ≈8 to 12 in. Max. (200 to 300 mm max.)

Three locking pin positions allow ≈2 in. / 50 mm riser adjustments.

All specifications subject to change without notice.

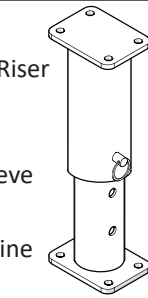

Riser

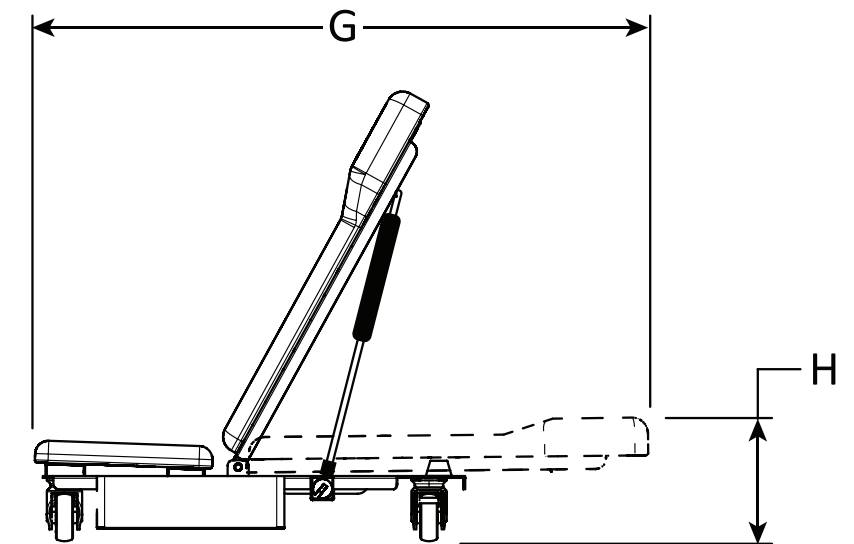
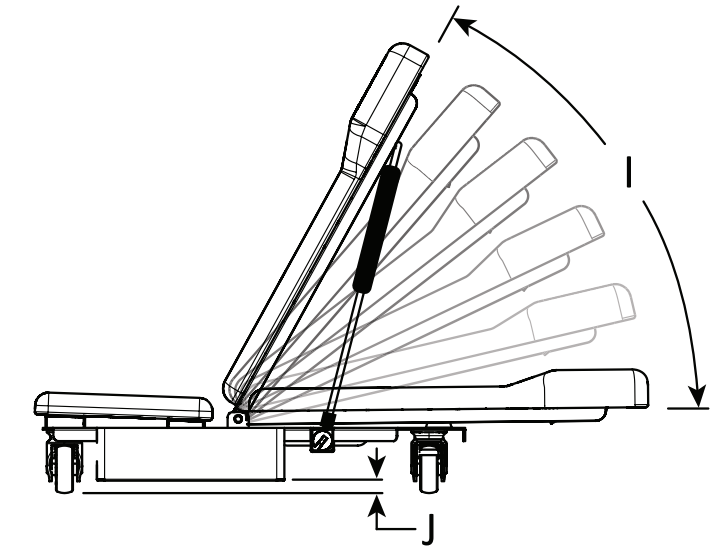
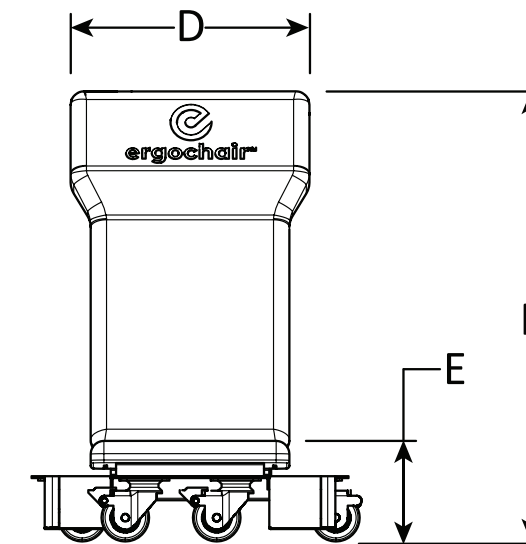
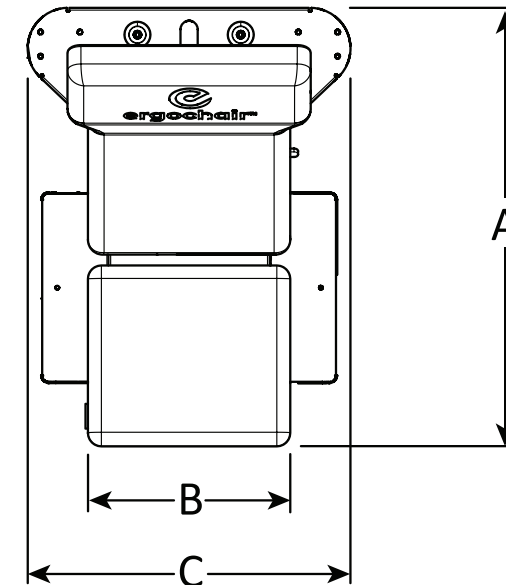

California Proposition 65: This product can expose you to chemicals including styrene and vinyl chloride, which are on the list of over 900 chemicals identified by the State of California to cause cancer, birth defects, or other reproductive harm. Always use this product in accordance with BendPak Ergochair's instructions. For more information, visit www.p65warnings.ca.gov.

Ergo - Scoot™ Low-Profile Creeper

Ergo-Scoot Assembly:

1. Open the box and remove the protective packing foam.
2. Carefully cut away the plastic holding the backrest to the seat. Do NOT damage the foam seat or backrest with the knife.
3. Set the backrest aside where it will not be lost or damaged.
4. Carefully remove the protective plastic from both side tool trays and remove the casters, fasteners, spring release and the gas spring. Place the components where they will not be lost or damaged.
5. Leave the seat on the cardboard shipping box.
6. Verify all the components are present using the parts list.
7. Configure the Scoot with or without spacers and optional risers.

a. Without Risers

- i. Turn over the seat and attach the two locking casters and spacers (optional) to the front of the seat using four SHCS M8 x 20, flat washers, and lock washers on each caster. (If using the optional spacers use the M8 x 40 SHCS.)
- ii. Attach the two swivel casters (without locks) and spacers (optional) to the rear of the seat using four SHCS M8 x 20 with flat washers, lock washers, and hex nuts on each caster. (If using the optional spacers use the M8 x 40 SHCS)

b. With Risers

- i. Attach four risers to the seat using four SHCS M8 x 20 with flat washers, lock washers, and hex nuts (verify the riser side with one hole is closest to the seat as shown to the right).
- ii. Attach the two locking casters to the front two risers using the SHCS M8 x 25 with flat washers, lock washers, and hex nuts.
- iii. Attach the two swivel casters (without locks) to the rear two risers using the SHCS M8 x 20 with flat washers, lock washers, and hex nuts.

8. Turn the seat onto its casters.
9. Install the backrest using two hex head bolts (HHB) M14 x 50 and two M14 nyloc nuts. *Do not overtighten*. The backrest must be able to move freely about the pivot points created by the fasteners.
10. Insert the spring release assembly into the square channel under the seat until the threaded opening is visible in the middle slot. The backrest spring release handle may be installed on either the right or left-hand side of the seat.
11. Thread the backrest gas spring all the way into the release mechanism.
12. Thread the lock nut and pad down the spring rod until it contacts the spring release mechanism. Make finger tight.
13. Insert the top of the gas spring into the backrest mounting flange.
14. Secure the spring to the mounting flange with the HHB M8 x 25 and nyloc nut.

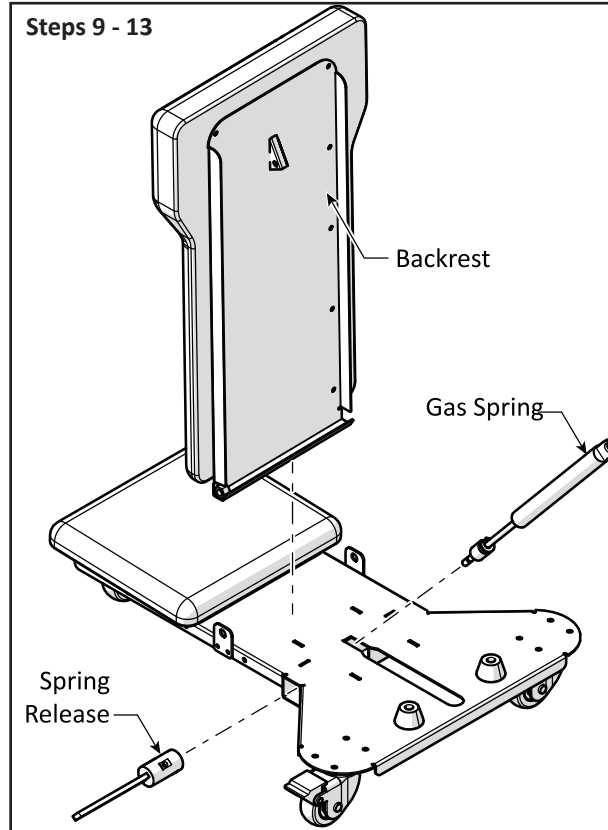
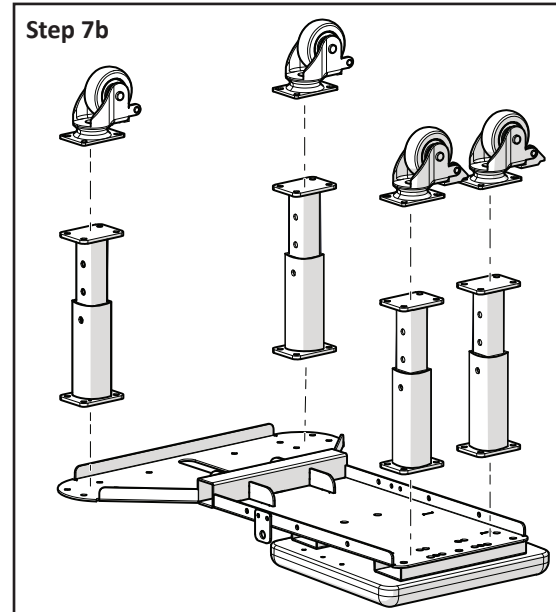
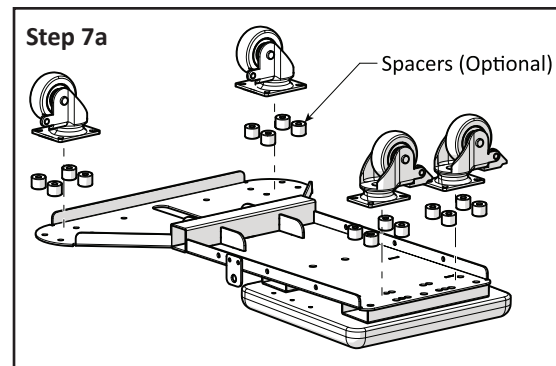
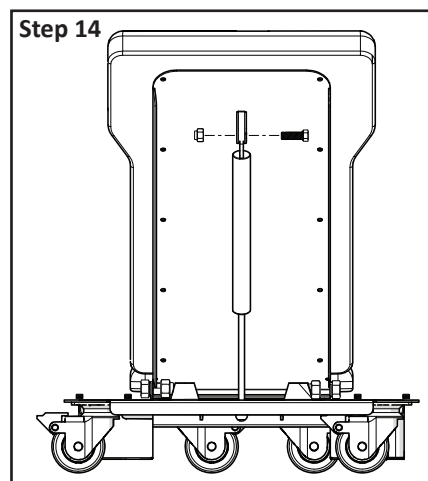

- a. Remove the M8 HHB and nut securing the spring to the backrest.
 - b. Loosen the lock nut and then attempt to tighten the gas spring an additional rotation.
 - c. Retighten the lock nut onto the release mechanism.
 - d. Reattach the gas spring to the backrest mounting flange and attempt to recline the backrest.
 - e. If the backrest does not recline, contact Ergochair.
16. Attach one tool tray to each side of the Scoot using three HHB M6 x 12 and M6 flanged lock nuts on each tool tray.

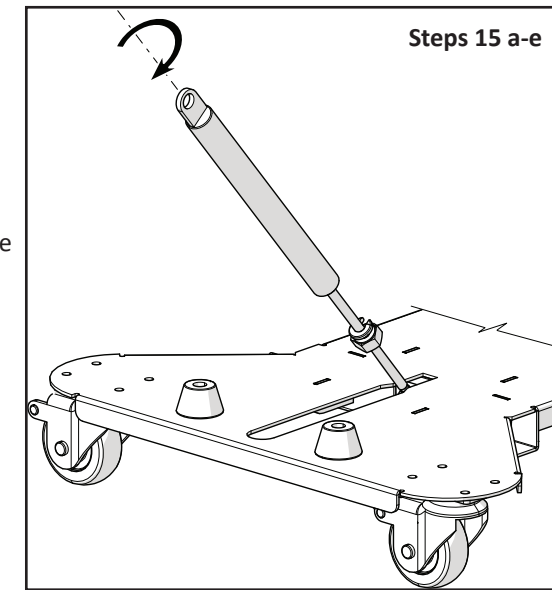

To clean the Ergo-Scoot:

1. While Marine Vinyl is water, stain and abrasion resistant, it is still a porous material which can become clogged with dirt. Wash the Scoot vinyl frequently using soap and water.
2. Wipe the Vinyl and the Frame of the Scoot and dry after cleaning.
3. If a more powerful cleaner is required, use a gentle cleaner, similar to Simple Green® or a small amount of dish soap and a soft bristle brush.
4. Rinse with water and wipe dry, then allow to air dry fully.
5. Do not use bleach, vinegar, alcohol or excessively acidic or basic cleaners. These can dry out the vinyl and cause cracking.
6. Store the Scoot in a clean, well ventilated and dry area.

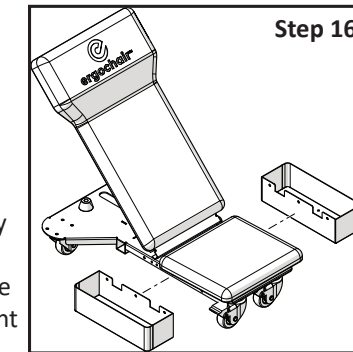

Parts List:

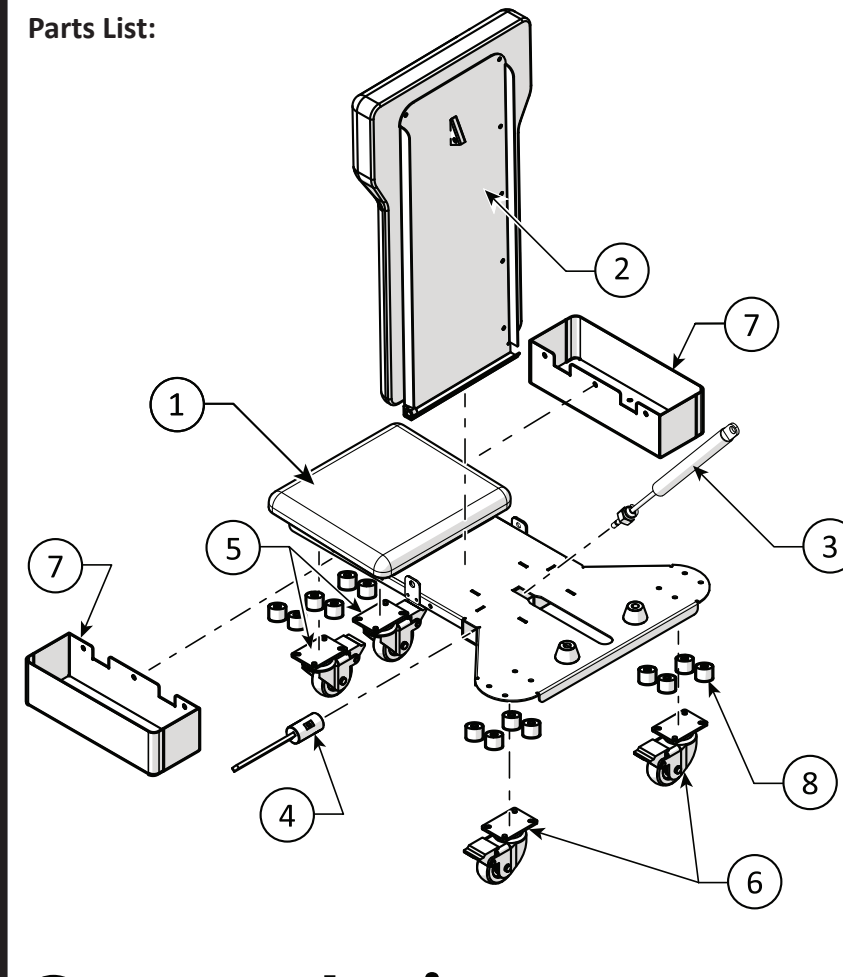

Item No.	Description	Qty.
1	SCOOT SEAT	1
2	SCOOT BACKREST	1
3	SCOOT BACKREST GAS SPRING	1
4	SCOOT SPRING RELEASE	1
5	LOCKING CASTER	2
6	SWIVEL CASTER	2
7	TOOL TRAY	2
8	Spacer 20 mm (Optional)	16
9	HHB M14 X 50 (Backrest Pivot Fasteners)	2
10	NUT, NYLOC M14 (Backrest Pivot Fasteners)	2
11	HHB M8 X 25 (Secures Backrest Gas Spring)	1
12	NUT, NYLOC M8 (Secures Backrest Gas Spring)	1
13	HHB M6 X 12 (Secures Tool Trays)	6
14	NUT, FLANGED LOCKING M6 (Secures Tool Trays)	6
15	SHCS M8 X 20 (Secures Casters)	32
16	WASHER, FLAT M8 (Secures Casters)	32
17	LOCK WASHER M8 (Secures Casters)	32
18	NUT, M8 (Secures Casters)	24
19	SHCS M8 x 40 (Spacer Kit)	16

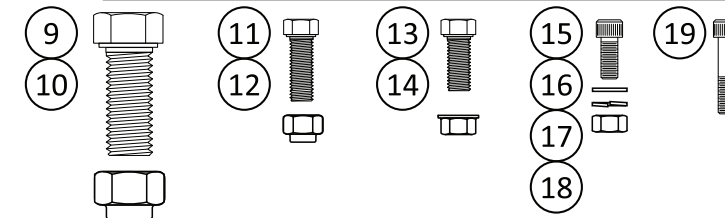

Ergochair™

Copyright ©2023 BendPak Inc. All rights reserved.

1645 Lemonwood Drive
Santa Paula, CA 93060 USA
(800) 253-2363 bendpak.com